

NOTES:
 1. THIS SET OF DRAWINGS IS TO BE USED AS A FULL SET. INDIVIDUAL SHEETS OR PAGES ARE NOT TO BE CONSTRUED AS A COMPLETE DESIGN.
 2. INVENTORY REVIEW PERFORMED NOVEMBER 2010 AND AUGUST 2011.
 3. SOILS DATA PROVIDED BY NRCS WEB SOIL SURVEY.
 4. UTILITY INFORMATION PROVIDED BY ENTECH ENGINEERING (NOV. 22, 2010) OR THE RESPECTIVE UTILITY COMPANY. INFORMATION IS PRESUMED CURRENT AS OF DAY RECEIVED.

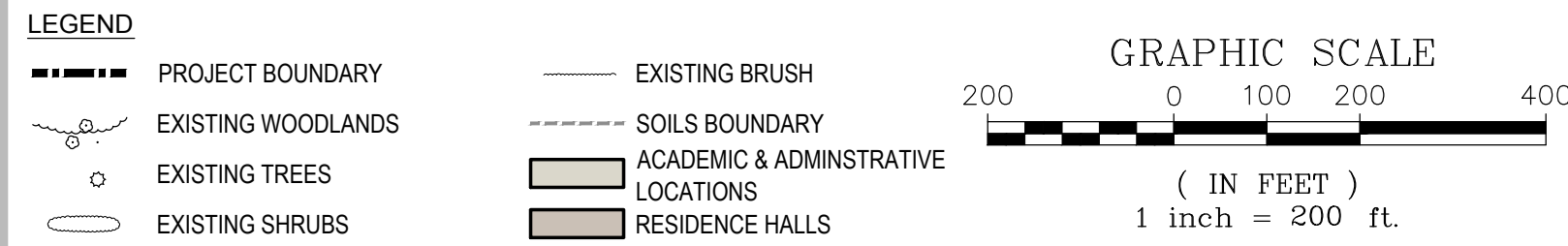

ACADEMIC AND ADMINISTRATIVE LOCATIONS		RESIDENCE HALLS	
1	CORSON HALL	A	944 MAIN STREET
2	UNITY HOUSE	B	942 MAIN STREET
3	BERMAN MUSEUM OF ART	C	201-203 NINTH AVENUE
4	OLIN HALL	D	CLOAK HOUSE
5	BOMBERGER HALL	E	ISENBERG HALL
5a	FETTEROLF HOUSE (CENTER FOR CONTINUOUS LEARNING)	F	732 MAIN STREET
6	MYRIN LIBRARY	G	ELLIOTT HOUSE
7	HILLEL HOUSE	H	TODD HALL
8	PFALER HALL	I	777 MAIN STREET
9	THOMAS HALL	J	WICKS HOUSE
10	KALEIDOSCOPE PERFORMING ARTS CENTER	K	OMWAKE HALL
11	BOOKSTORE	L	REIMERT HALL
12	WISMER CENTER	M	CURTIS HALL
13	CAMPUS SAFETY	N	WILKINSON HALL
14	FACILITIES SERVICES	O	BRODBECK HALL
15	FLOY LEWIS BAKES CENTER (INCLUDING HELFFERICH HALL GYM)	P	702 MAIN STREET
16	RITTER CENTER	Q	SCHAFF HALL
17	PRACTICE FIELD (SOUTH)	R	OLEVIAN HALL
18	PATTERSON FOOTBALL FIELD	S	624 MAIN STREET
19	SNELL FIELD HOCKEY FIELD	T	ZWINGLI HALL
20	BASEBALL FIELD	U	DURYEA HALL
21	TENNIS COURTS	V	SCHREINER HALL
22	SOFTBALL FIELD	W	MUSSER HALL
23	PRACTICE FIELD (NORTH)	X	HOBSON HALL
24	SOCCER AND LACROSSE FIELD	Y	STURGIS HALL
25	HUNSBERGER WOODS	Z	30-32 SIXTH AVENUE
		AA	BEARDWOOD HALL
		BB	PAISLEY HALL
		CC	STAUFFER HALL
		DD	RICHTER HALL
		EE	NORTH HALL
		FF	FETTEROLF HALL
		GG	MAPLES HALL
		HH	KEIGWIN HALL
		II	COMMONWEALTH
		JJ	NEW HALL
		KK	BARBERSHOP
		LL	CLAMER HALL
		MM	444 MAIN STREET
		NN	424-426 MAIN STREET
		XX	SPRANKLE HALL

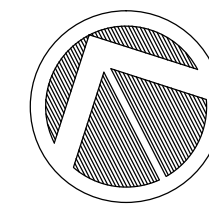
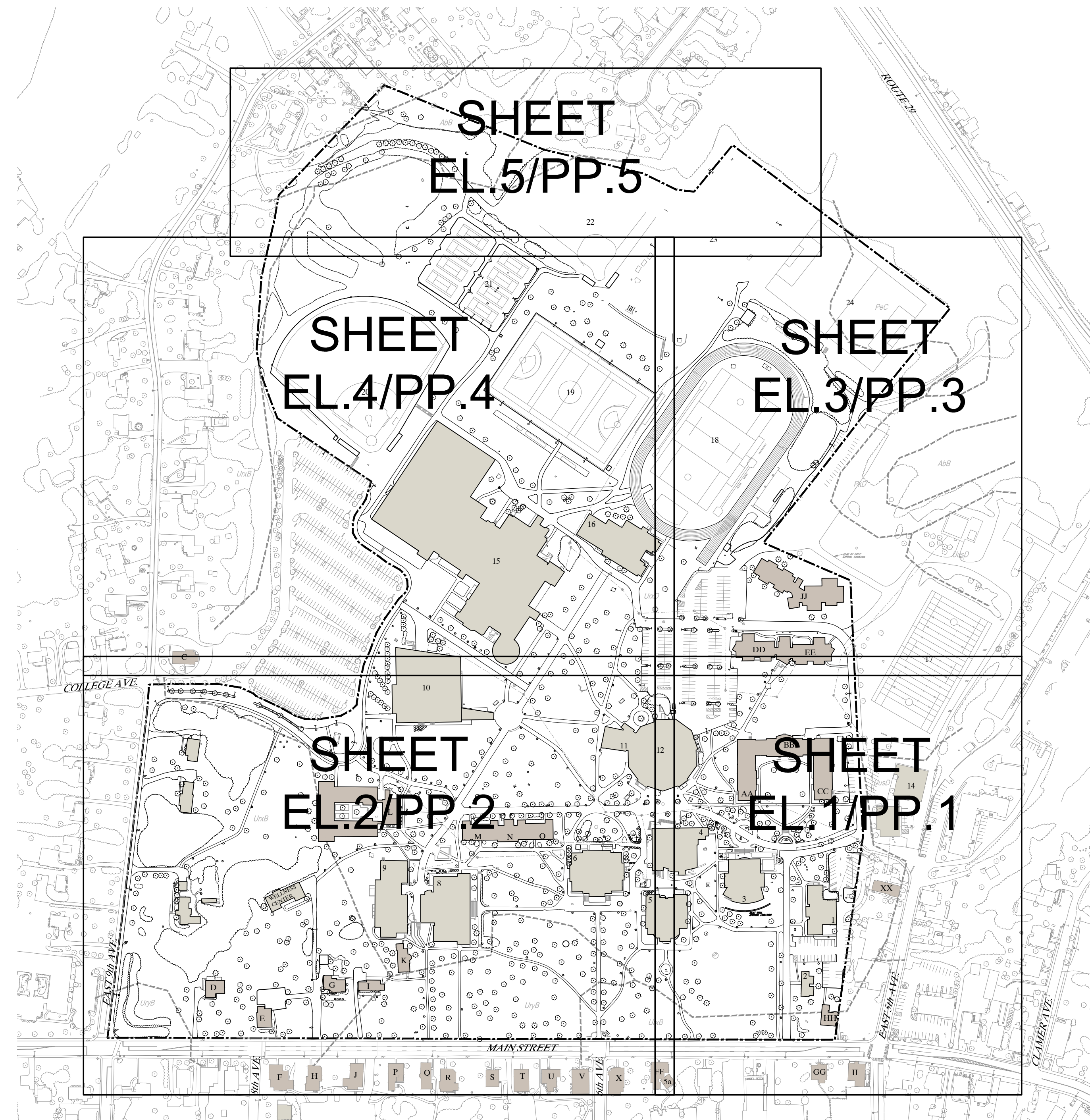

LIST OF DRAWINGS:

1. K.1 KEY MAP
2. EL.1 EXISTING TREE INVENTORY
3. EL.2 EXISTING TREE INVENTORY
4. EL.3 EXISTING TREE INVENTORY
5. EL.4 EXISTING TREE INVENTORY
6. EL.5 EXISTING TREE INVENTORY
7. SA.1 SITE ANALYSIS: EXISTING FEATURES PLAN
8. SA.2 SITE ANALYSIS: ENVIRONMENTAL CONDITIONS PLAN
9. SA.3 SITE ANALYSIS: CIRCULATION AND EXTERIOR SPACES PLAN
10. SA.4 SITE ANALYSIS: OPPORTUNITIES AND CONSTRAINTS PLAN
11. C.1 CONCEPT PLAN
12. PP.1 PLANTING PLAN
13. PP.2 PLANTING PLAN
14. PP.3 PLANTING PLAN
15. PP.4 PLANTING PLAN
16. PP.5 PLANTING PLAN
17. MP.1 ILLUSTRATIVE PLAN

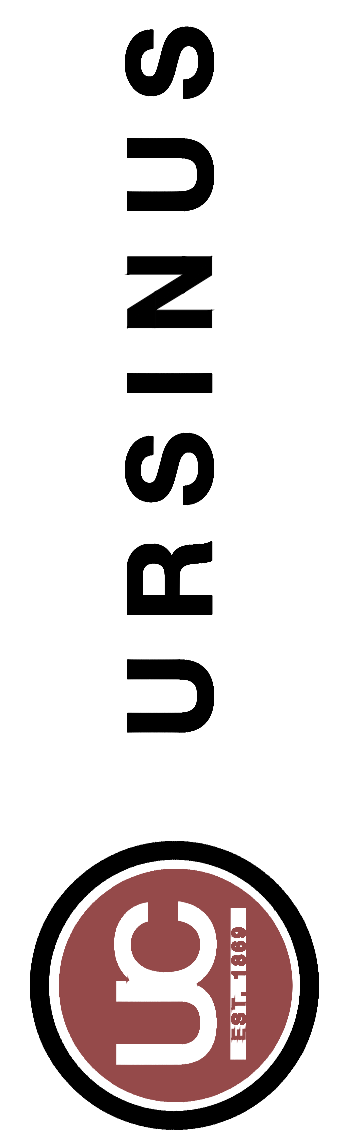

Key Map
Tree Master Plan

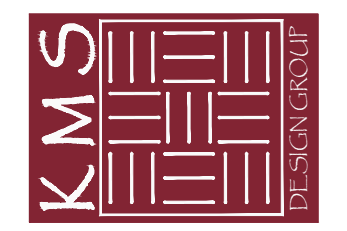

Stop-Call Before You Dig!
 PENNSYLVANIA ACT 187 (1996) REQUIRES NOTIFICATION BY EXCAVATORS, DESIGNERS, OR ANY PERSON PREPARING TO DISTURB THE EARTH'S SURFACE ANYWHERE IN THE COMMONWEALTH.
Pennsylvania One Call System, Inc.
 1-800-242-1776
 SERIAL NO. 20103231861

DWN BY: GJF CHK BY: AAS
 DATE: 11/21/2011 SCALE: 1" = 200'
 JOB NO: K10013
SHEET: K.1 1 of 17